

| Revision Level | | | Revision Record | Changed | Date | Approved | Date |
|----------------|----------------|------|-----------------|---------|----------|----------|----------|
| Drawing | State | Part | | | | | |
| 01.1 | Design Release | - | SEE ECN# 014226 | CTF | 12/11/17 | KAC | 12/11/17 |

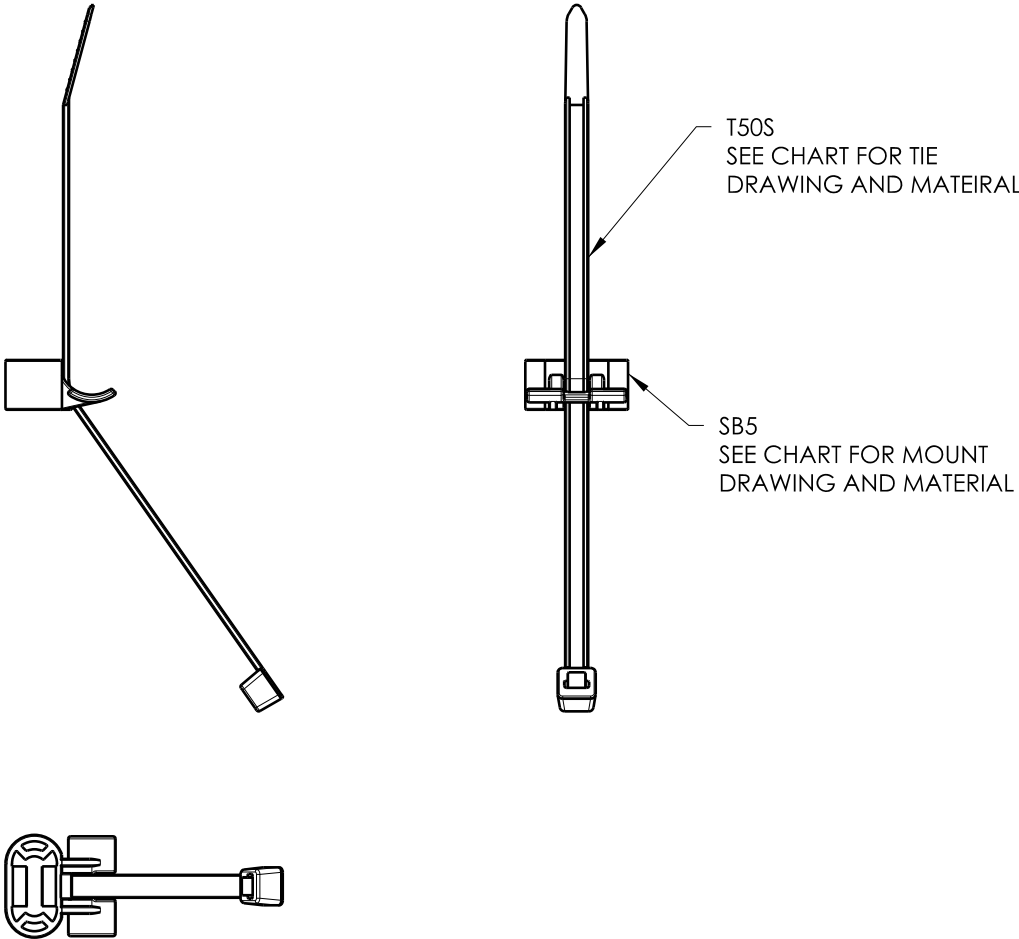

| GLOBAL PART NAME | BUNDLE RANGE | CABLE TIE | | | MOUNT | | |
|-----------------------|--------------|--------------|----------|-------|----------------|----------|-------|
| | | DRAWING | MATERIAL | COLOR | DRAWING | MATERIAL | COLOR |
| T50SSB5-POM/PA66HS-BK | 1.5 to 35mm | CT2050006CST | PA66HS | BLACK | XMT-HTC010-CSU | POM | BLACK |

Material
SEE CHART
COLOR: SEE CHART

Units **millimeters**

Tolerance defined on
each dimension

The copyright of this drawing is reserved by HellermannTyton. It is issued on condition that it is not reproduced, copied or disclosed to a third party, either wholly or in part, without the consent of HellermannTyton.

| | | |
|----------|-----|----------|
| Drawn | CTF | 12/11/17 |
| Approved | KAC | 12/11/17 |



North America
Email: corp@htamericas.com
Web: www.hellermann.tyton.com

| | | | |
|-----------------|-------------------------------|-------|----------------|
| Article/Type-No | T50SSB5 | Scale | 2:3 |
| Title | T50S CABLE TIE WITH SB5 MOUNT | | Project Number |
| 94-0101 | | | |
| Drawing-No | PRODUCTION : Phase | | Format |
| 94-0101-101-CSU | | AH | |
| | | Sheet | |
| | | 1/1 | |