

SW

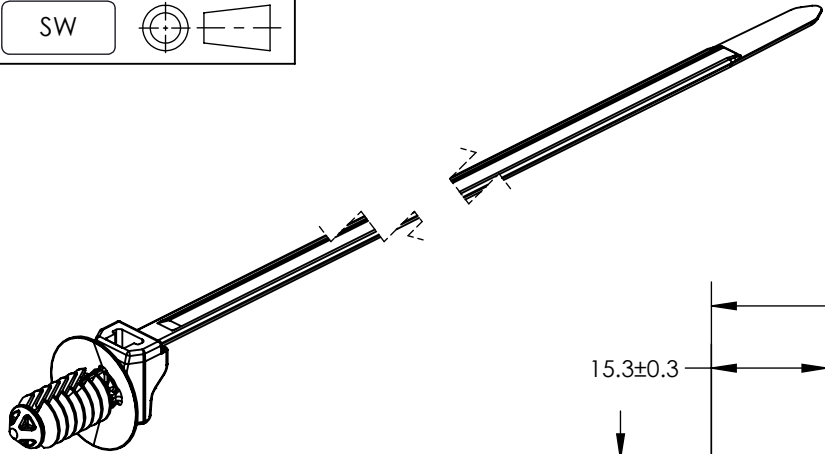

Revision level			Revision Record	Changed	Date	Approved	Date
Drawing	State	Part					
00.0	Design Release	-	SEE ECN# 017479	GJD	04/13/23	JMC	04/13/23

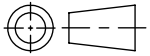
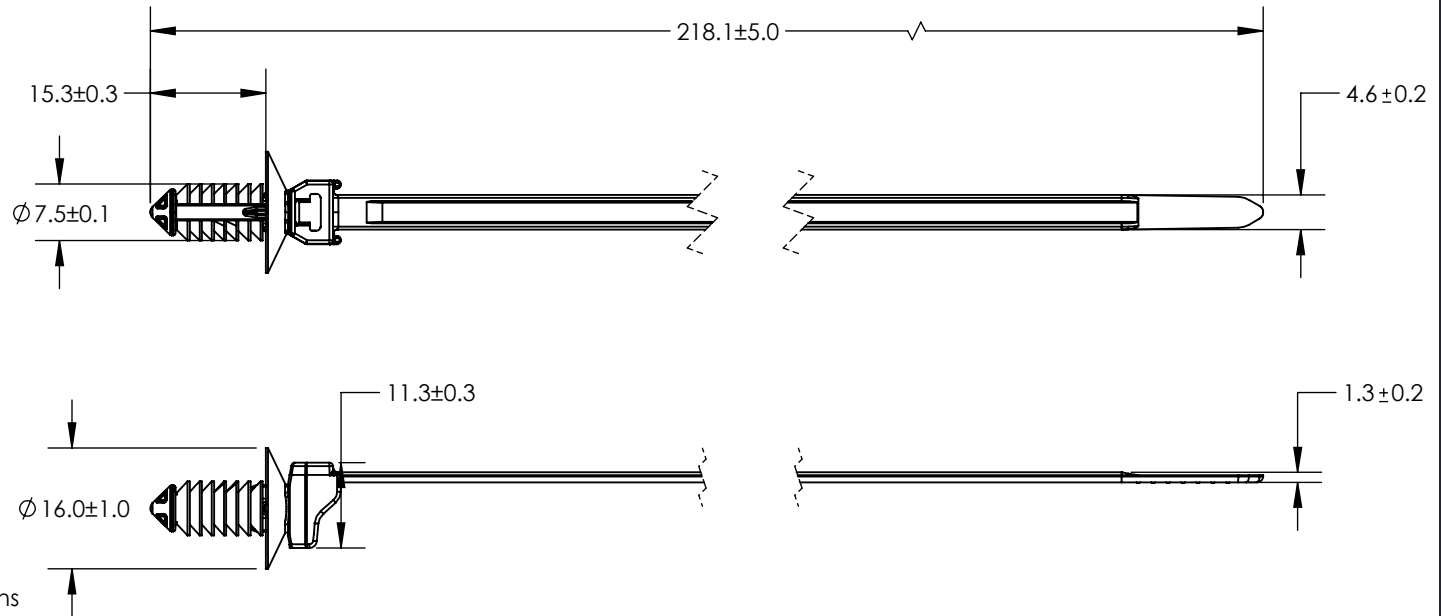

Reference:

Performance requirements at dry as molded:

1. Fir tree push in force: 45 newtons (10 lbf) max in the applicable nominal hole size and a plate thickness of 1.8mm.
2. Fir tree pull out force: 110 newtons (25 lbf) min in the applicable nominal hole size and a plate thickness of 1.8mm.
3. Cable tie min. loop tensile strength: 225Newtons (50 lbs) min

Notes:

1. Material: See chart
2. Material color: See chart
4. Max allowable flash to be: 0.4mm
5. Max allowable mismatch to be: 0.4mm
6. Sheet metal thickness range: 0.60mm - 8.25mm
7. Applicable hole size:
 - A. 6.5mm +/- 0.4mm
 - B. 6.35mm +/-0.25 Hex

*Some stress whitening may occur at bundles ≤8.0mm

GLOBAL PART DESCRIPTION			MATERIAL	COLOR	BUNDLE RANGE*
T50ROSFT6.5LG-E4-PA66HIRHS(REC100)-BK			PA66HIRHS(REC100)	BLACK	4 to 50mm
Drawn	GJD	04/13/23	Article/Type-No		Scale 1:1
Approved	JMC	04/13/23	Title		Project Number
<div>HellermannTyton</div> <div>North America</div> <div>Email: corp@htamericas.com</div> <div>Web: www.hellermann.tyton.com</div>			T50ROSFT6.5LG-E4 OUTSIDE SERRATED WITH 6.5mm FIR TREE		PRP 16-1353
			Drawing-No		Format AH
			Production : Phase		Sheet 1/1
			16-1353-081-CSU		

Material
SEE CHART

Units: millimeters

Dimension without
tolerances details to:

.xxx = ±.013

.xx = ±.13

.x = ±.3

None = ±.8

∠ = ±0.5°

Dimension Formatted mm/[in]

The copyright of this drawing is reserved by HellermannTyton. It is issued on condition that it is not reproduced, copied, or disclosed to a third party, either wholly or in part, without the consent of HellermannTyton.